

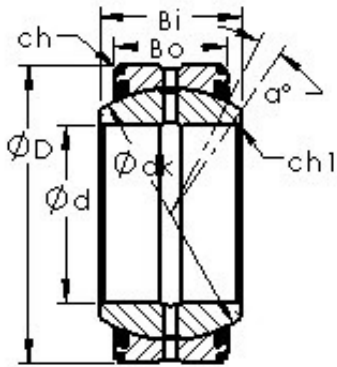

BEARING PRECISION AXLE CORP.



AST GEC360XS-2RS plain bearings

Bearing No. GEC360XS-2RS

Bore Diameter	360 mm
Outer Diameter	480 mm
Bearing Type	large size, sealed
Bore Dia (d)	360.0000
Outer Dia (D)	480.0000
Outer Width (Bo)	135.0000
Inner Width (Bi)	160.0000
Dynamic Load Rating (Cr)	4,800,000
Static Load Rating (Cor)	24,000,000
Max. shaft corner radius, or 45 deg. chamfer (ch1)	1.100
Max. housing corner radius, or 45 deg. chamfer (ch)	3.000
Spherical Diameter (dk or Dk)	420.000
Mis-alignment Angle (α deg.)	3
Weight (g)	87,000.00
Material	Inner and Outer ring made from 52100 Chrome steel, or equivalent

GEC360XS-2RS Bearing 2D drawings and 3D CAD models