

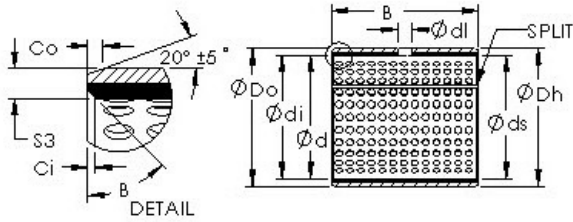

# BEARING PRECISION AXLE CORP.



## AST AST20 110110 plain bearings

Bearing No. AST20 110110

Bore Diameter	110 mm
Outer Diameter	115 mm
Bearing Type	straight
Shaft Dia., Nominal (d)	110.0000
Shaft Size (ds) - 110 +0 / -0.054	110 +0 / 0.054
Housing Bore Dia. (Dh) - 115 +0.035 / -0	115 +0.035 / 0
Bearing Outside Diameter, Nominal(Do)	115.000
Bearing Outside Diameter Tolerance (Do tol.)	115.120 / 115.070
Bearing Bore after Mounting (di)	110.265 / 110.110
Average Clearance (Cd)	0.2110
Wall Thickness (S3)	2.418
Bearing Length, Nominal (B)	110.000
Bearing Length Tolerance (B tol.) - +0 / -0.40	+0 / 0.40
OD Chamfer Length (Co)	1.800
ID Chamfer Angle (B deg.)	45
ID Chamfer Length (Ci)	0.800
Lube Hole Dia. (dl)	9.500
Material	Carbon steel shell with POM plastic liner

AST20 110110 Bearing 2D drawings and 3D CAD models