

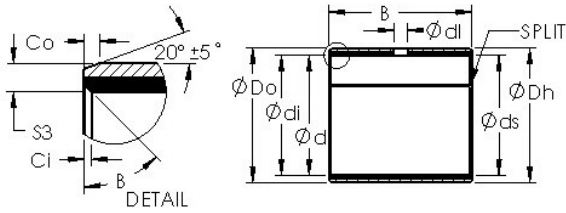

BEARING PRECISION AXLE CORP.



AST AST50 581B48 plain bearings

Bearing No. AST50 581B48

Bore Diameter	92,075 mm
Bearing Type	straight
Shaft Dia., Nominal (d)	3.6250
Shaft Size (ds) - 3.625	3.6228
Housing Bore Dia. (Dh) - 3.8122	3.8108
Bearing Bore after Mounting (di) - 3.6318	3.6252
Average Clearance (Cd)	0.0046
Wall Thickness (S3)	0.095
Bearing Length, Nominal (B)	3.000
Bearing Length Tolerance (B tol.) - +.010 / -0.010	+.010 / 0.010
OD Chamfer Length (Co)	0.072
ID Chamfer Angle (B deg.)	30
ID Chamfer Length (Ci)	0.031
Material	Carbon steel shell with PTFE / Fiber lining

AST50 581B48 Bearing 2D drawings and 3D CAD models